

WORKS NOTIFICATION - GEOTECHNICAL INVESTIGATIONS HEYBRIDGE

We are undertaking important surveys and investigations to help us understand local conditions and plan for Marinus Link.

You will see activity around **Heybridge** including a **self-levelling platform** in the nearshore environment from late May 2022.

Geotechnical investigations will be carried out from the platform Monday to Friday, during daylight hours over a period of approximately three weeks.

The investigations are taking place to help us understand the conditions of the seafloor and will involve taking core samples. The information collected will help us refine the route and construction methods. We are working to minimise any impact on the environment, community and cultural heritage.

Please note that the timing of these investigations are subject to weather and the impacts of COVID-19.

WHAT YOU MAY SEE:

- ◇ **Marinus Link team members including contractors on the beach and nearshore at Heybridge.**
- ◇ **A self-levelling platform and investigation equipment.**
- ◇ **Lights from the self-levelling platform at night time for navigational and safety purposes.**

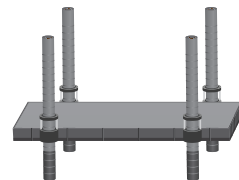

Things to note:

- ◇ **There will be no seismic testing undertaken as part of this investigation.**
- ◇ **This is not an oil or gas exploration platform.**
- ◇ **Similar equipment was used previously for investigations in the dune area near Heybridge.**
- ◇ **Lights will be directed to ensure minimal visual impact during night time hours.**



Picture: indicative illustration of a self-leveling platform in the nearshore environment at Heybridge.

BACKGROUND

Marinus link is a proposed 1500 megawatt capacity undersea and underground electricity and telecommunications connection to further link Tasmania and Victoria as part of Australia's future electricity grid.

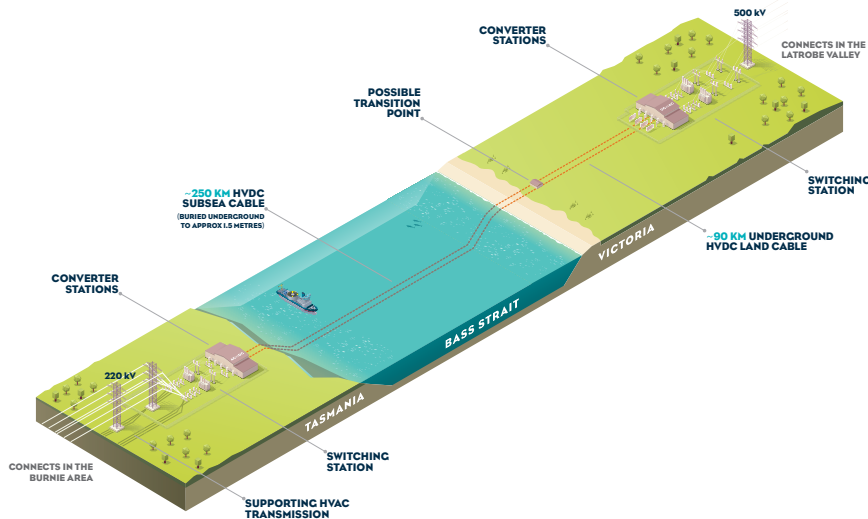

Marinus Link involves approximately 255 kilometres of undersea High Voltage Direct Current (HVDC) cabling in Bass Strait and 90 kilometres of underground HVDC cabling in Victoria. It will include converter stations in Tasmania and Victoria.

Get in touch with us

Email: team@marinuslink.com.au

Phone: **1300 765 275**

Facebook: [@marinuslink](https://www.facebook.com/marinuslink)

For more information

Website: marinuslink.com.au